

TWO TRACK SLIDING INSECT SCREEN ORDER FORM

CUSTOMER:

Order No.

Ordered on

Date of delivery

Sliding insect screen profiles

MPR frame profile

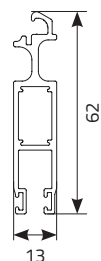

side channel / frame profile

U type

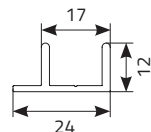

F2 type

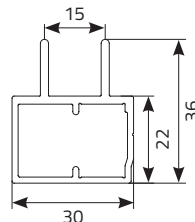

Two panel, two track insect screen

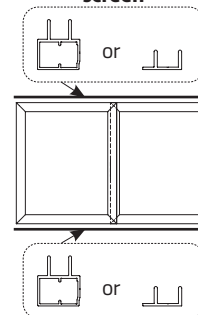

Two panel, two track insect screen with frame

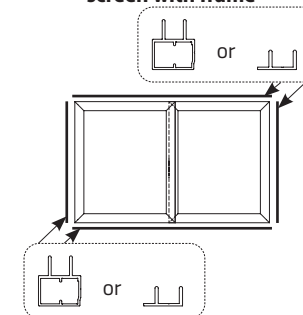

Screen dimensions (mm)			Qty	Side channel profile (write U or F2)				Profile colour										Mesh colour			Length of side channels (L) ⁽⁷⁾		
Width		Height (H)		top	bottom	frame (seen from the outside)		white RAL 9003	brown RAL 8017	anthracite RAL 7016	basalt grey RAL 7012	grey-black matt RAL 7021	black matt RAL 9005	RAL ⁽⁵⁾	laminate				grey	black	aluminium ⁽⁶⁾	two panels (standard = (B1 + B2) + 40 mm	
(L) total width	fill in when ordering asymmetrical panels					left	right								golden oak	walnut	winchester	turner oak					
	(B1)																						(B2)
1			2	3				4									5			6			

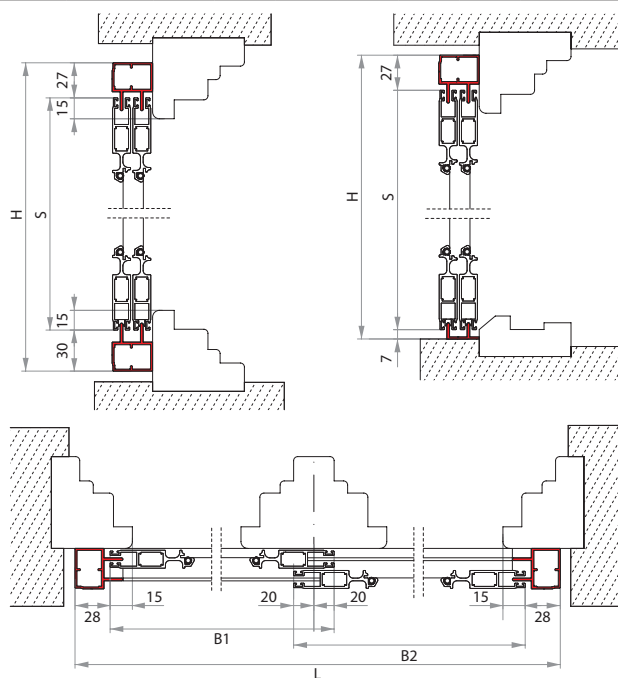
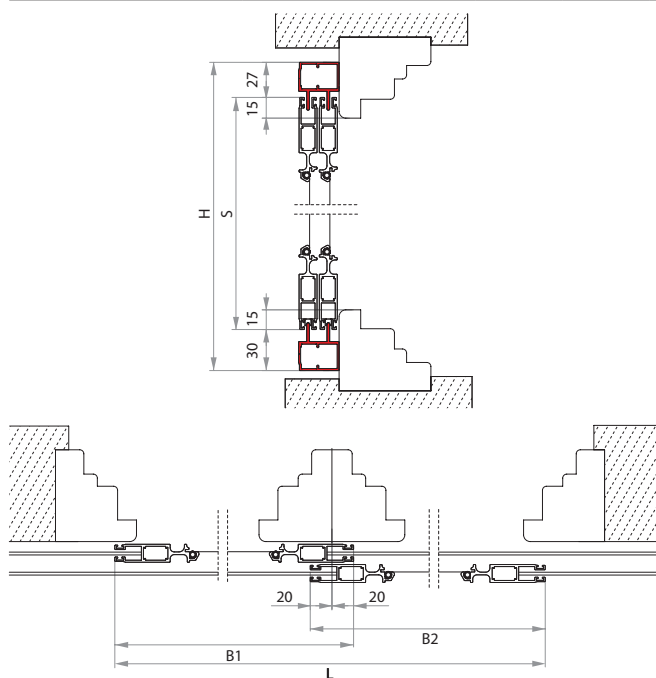

DIMENSIONS

Width (B) = width of panel

Height (H) = overall height (incl. top and bottom side channels)

Insect screen frame dimensions			
width (mm)		height (mm)	
min.	max	min.	max
600	2000	600	2500

Please note:

- 1 Min. space between roller shutter curtain and the window frame is 16 mm.
- 2 Please ensure that the bottom side channel does not obstruct the flow of water from the window frame.
- 3 In order to ensure effective protection against insects, the minimum screen overlap on the window frame should be 15 mm (on one side); this may vary with window frames at more acute angle.
- 4 The standard sliding insect screen consists of panels which are divided symmetrically.
- 5 Any colour from the RAL palette except pearly, metallic and fluorescent colours.
- 6 Max. width of a panel with aluminium mesh: 1100 mm.
- 7 Column 6 is applicable in case of nonstandard width of side channels only.

.....
legible signature of the Customer